

Hannah Hart

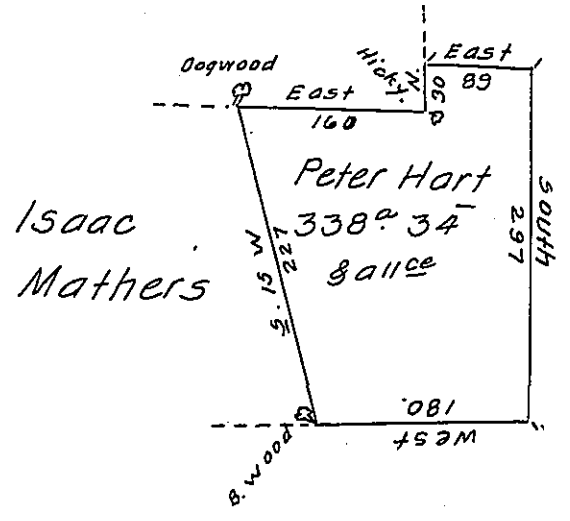

By Virtue of a Warrant dated the 11th day of December 1793. Surveyed the 24th day of June 1794 to Peter Hart the above described Tract of Land situate on the East side of the North East branch of Susquehanna — in Luzerne County Containing three hundred and thirty eight Acres and thirty four perches and Allow^{ce} of Six $\frac{1}{2}$ Cent &c.

To Daniel Brodhead Esq^r } Ant^y Crothers D.S.
 Surveyor General }

IN TESTIMONY that the above is a copy of the original remaining on file in the Department of Internal Affairs of Pennsylvania, made conformably to an Act of Assembly approved the 16th day of February, 1833, I have hereunto set my Hand and caused the Seal of said Department to be affixed at Harrisburg, this ninth day of December 1907.

Henry Howell
 Secretary of Internal Affairs.